

THIS DRAWING IS UNPUBLISHED. RELEASED FOR PUBLICATION
 © COPYRIGHT - By - TE CONNECTIVITY ALL RIGHTS RESERVED.

LOC	DIST	REVISIONS					
HB	-	P	LTR	DESCRIPTION	DATE	DWN	APVD
		E		REMOVED CSA&OPTIMIZATION SSA RATING&USING WELDED CONTACT ECO-13-017354	14Feb2014	HYS	B.F

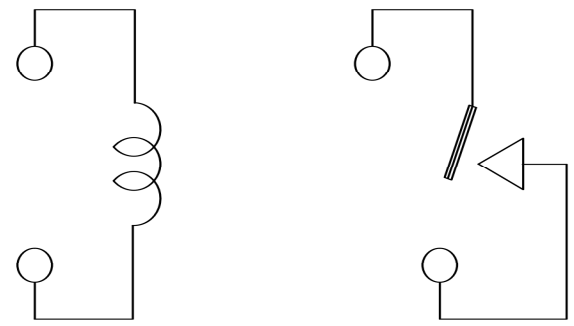

CONNECTION FIGURE

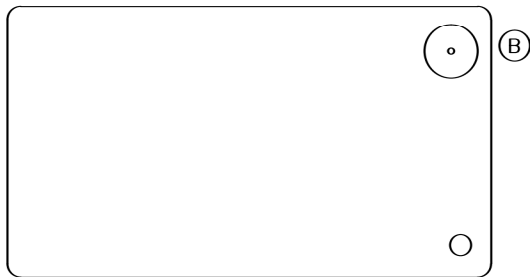
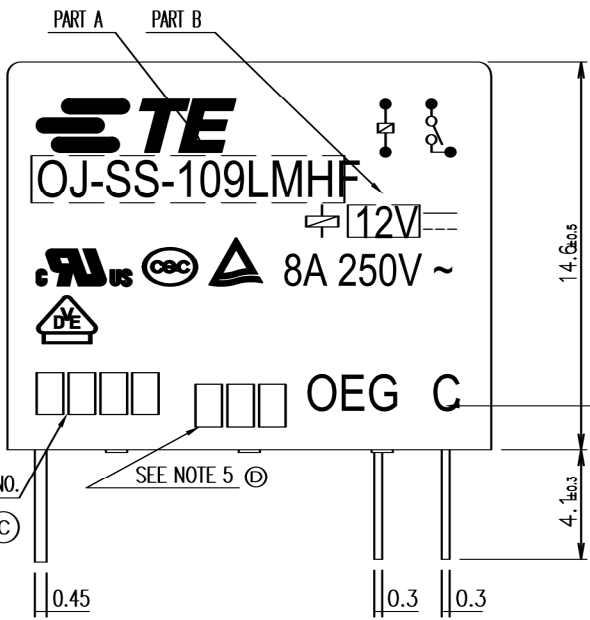

MADE IN CHINA

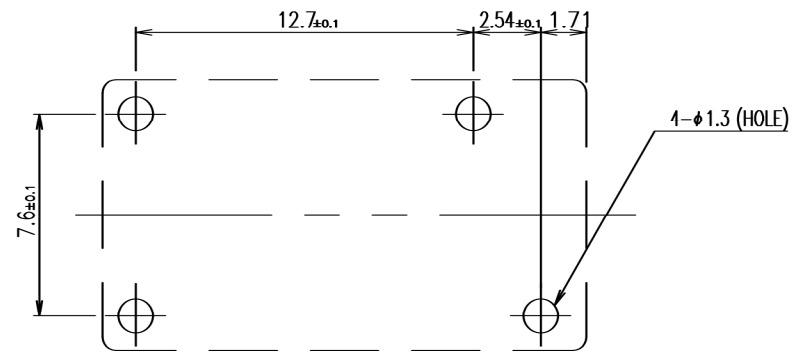
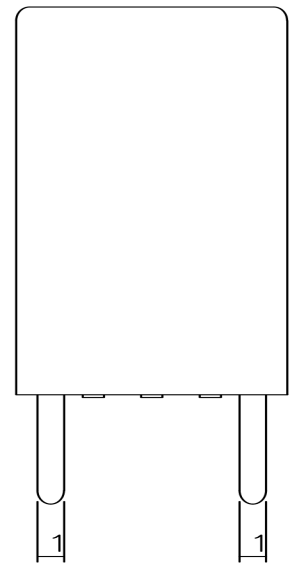
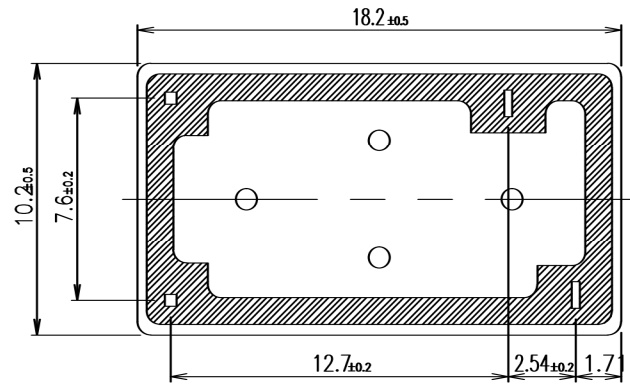

FIGURE FOR PRINTED CIRCUIT BOARD PROCESSING (BOTTOM VIEW)

Diagram dimension	Tolerance
0.99mm max.	±0.1mm
1 - 2.99mm	±0.2mm
3mm min.	±0.3mm



THIS DRAWING IS A CONTROLLED DOCUMENT.		DWN	H.SASAKI	-
		CHK	N.FUNAYAMA	-
		APVD	A.NAGAI	-
		PRODUCT SPEC	-	NAME
		APPLICATION SPEC	-	OJ-LMH STANDARD CUSTOMER DRAWING
		WEIGHT	-	RESTRICTED TO
		A3 00779 C= 1721083		-
		CUSTOMER DRAWING	SCALE 5:1	SHEET 1 of 2
				REV E

THIS DRAWING IS UNPUBLISHED. RELEASED FOR PUBLICATION
 © COPYRIGHT - By - TE CONNECTIVITY ALL RIGHTS RESERVED.

LOC	DIST	REVISIONS					
HB	-	P	LTR	DESCRIPTION	DATE	DWN	APVD
		-		SEE SHEET 1	-	-	-

Ⓓ Ⓐ	OBSOLETE	1721083-6	OJ-SS-118LMHF, 000	18V	OJ-SS-118LMHF	g
Ⓐ	ACTIVE	1721083-5	OJ-SS-109LMHF, 000	9V	OJ-SS-109LMHF	f
Ⓓ Ⓐ	OBSOLETE	1721083-4	OJ-SS-106LMHF, 000	6V	OJ-SS-106LMHF	e
Ⓓ Ⓐ	OBSOLETE	1721083-3	OJ-SS-105LMHF, 000	5V	OJ-SS-105LMHF	d
Ⓓ Ⓐ	OBSOLETE	1721083-2	OJ-SS-103LMHF, 000	3V	OJ-SS-103LMHF	c
	ACTIVE	1721083-1	OJ-SS-112LMHF, 000	12V	OJ-SS-112LMHF	b
	ACTIVE	1461014-2	OJ-SS-124LMHF, 000	24V	OJ-SS-124LMHF	a
	PART STATUS	TE PART NO	DESCRIPTION	PART B	PART A	TYPE

RELAY TYPE

Ⓒ Ⓓ NOTES:

1. LOT NO. SYSTEM AS FOLLOWING: Ⓓ 5. ADD LOT NO. SYSTEM AS FOLLOWING;

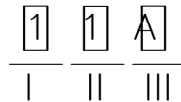
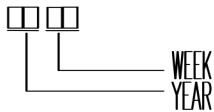

I, DIGITS FOR DAY OF THE WEEK
 1...MONDAY IN THIS WEEK;
 2...TUESDAY IN THIS WEEK;

 7...SUNDAY IN THIS WEEK

II, DIGITS FOR SHIFT OF THE DAY
 1...DAY SHIFT IN THIS DAY;
 2...NIGHT SHIFT IN THIS DAY;

III, ONE CHARACTER DISTINGUISH THE LINE IDENTITY,
 SUCH AS: A,B,....Z

Ⓓ 2. TERMINAL DIMENSION IS BEFORE SOLDER DIP;

Ⓓ 3. FOR THE TIN-PLATING OF THE PINS:
 +0.1mm FOR WIDTH, THICKNESS AND DIAMETER.
 +0.5mm FOR LENGTH.

Ⓒ Ⓓ 4. MARKING FROM INK TO LASER AND WELDED CONTACT

		EPOXY RESIN	SEAL (BASE & BOBBIN)	15
		MW79	MAGNETIC WIRE	14
94V-0		P.B.T	CASE	13
94V-0		P.B.T	BASE	12
94VHB		NYRON	BOBBIN	11
	SOLDER DIP	C.P WIRE	COIL TERMINAL	10
94V-0		P.P.S	CARD	9
		Ag ALLOY	MOVABLE CONTACT	8
		Ag ALLOY	NO.CONTACT	7
		STEEL	HINGE SPRING	6
	SOLDER DIP	Cu ALLOY	NO.TERMINAL	5
	SOLDER DIP	Cu ALLOY	MOVABLE SPRING	4
	NIP	STEEL	CORE	3
	NIP	STEEL	ARMATURE	2
	NIP	STEEL	YOKE	1
INCOMBUSTIBILITY	TREATMENT	MATERIAL	DESCRIPTION	ITEM

THIS DRAWING IS A CONTROLLED DOCUMENT.		DWN	H,SASAKI	-
DIMENSIONS: mm		CHK	N.FUNAYAMA	-
TOLERANCES UNLESS OTHERWISE SPECIFIED:		APVD	A.NAGAI	-
	0 PLC	± -	PRODUCT SPEC	-
	1 PLC	± -	APPLICATION SPEC	-
	2 PLC	± -	WEIGHT	-
	3 PLC	± -	CUSTOMER DRAWING	-
4 PLC	± -	SCALE	5:1	-
ANGLES	± -	FINISH	-	-
MATERIAL	-	FINISH	-	-

TE Connectivity

OJ-LMH STANDARD CUSTOMER DRAWING

SIZE	CAGE CODE	DRAWING NO	RESTRICTED TO
A3	00779	C- 1721083	-
SHEET		2 of 2	REV E